

MIDNIGHT RAMBLER

OVERALL SPACE VIBE

IT'S DARK GLAMOUR.

IT'S INTIMATE, BUT SHOWY.  
OPULENT WITH AN ATTITUDE.

IT'S SEXY, MOODY, AND  
UNEXPECTEDLY FASCINATING.







*ACTUAL PHOTOS FOR REFERENCE OF ORIGINAL  
MIDNIGHT RAMBLER BAR: DALLAS TEXAS.*



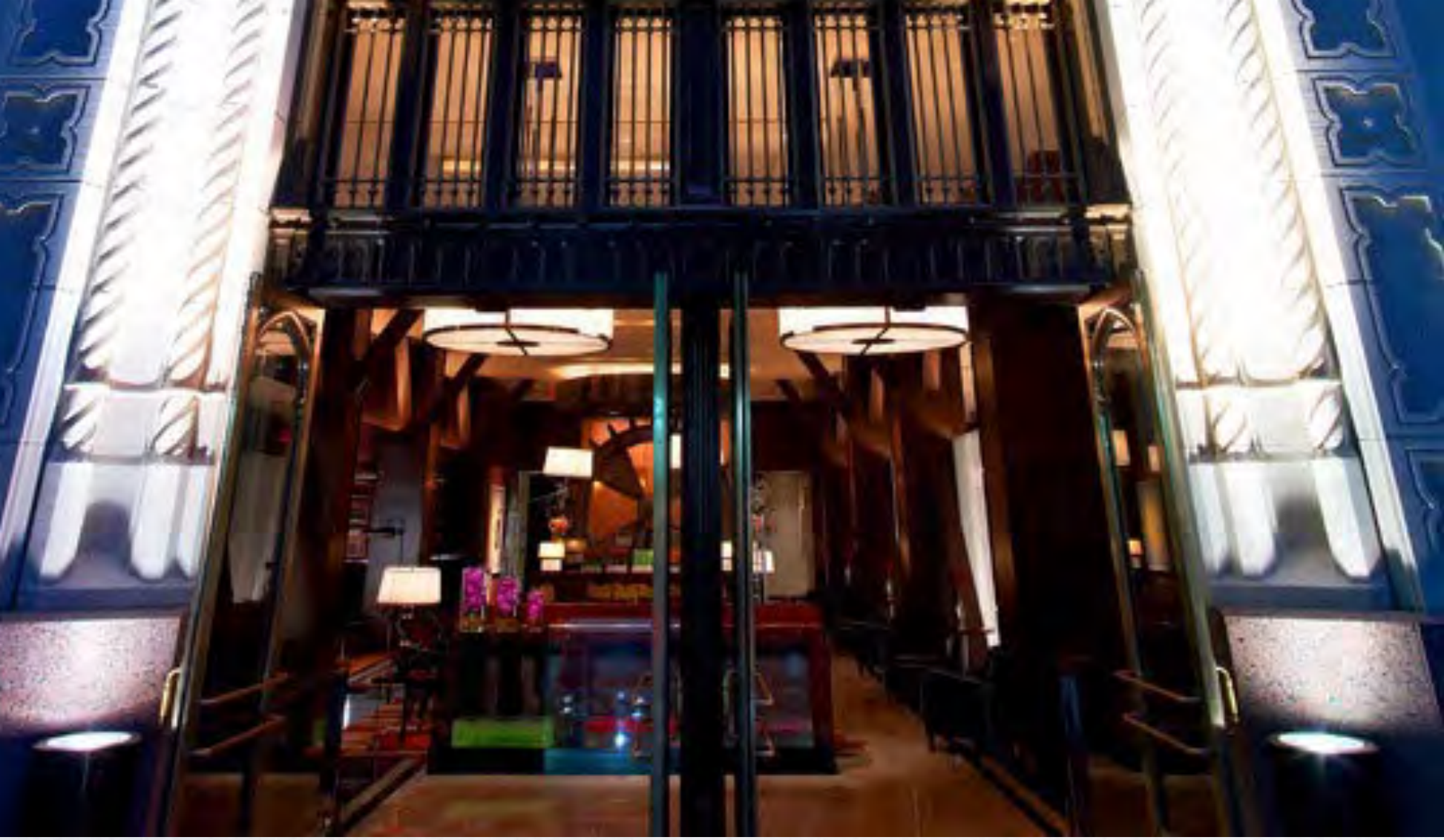



# FLOORPLAN



# FLOORPLAN

## EXTERIOR WALLS

all 12' high 6" deep

- LEFT: 31' 6" w
- RIGHT: 31' 6" w
- BACK: 44' 2" w
- FRONT L: 23' 1" w
- FRONT L: 23' 1" w
- FRONT R: 25' 1" w
- ENTRANCE SPACE: 27' 4" w
- STEP IN: 27' 4" / 1' 1"

## INTERIOR ALIGNMENT

PERIMETER SEATING 5' w

LEFT CLOSET 5' / 3' 11"

RIGHT CUBBY 2' 6" / 3'

UPPER ROOM 6' / 10' / 12'

KITCHEN 25' 6" / 6'

## EXTERIOR WALLS

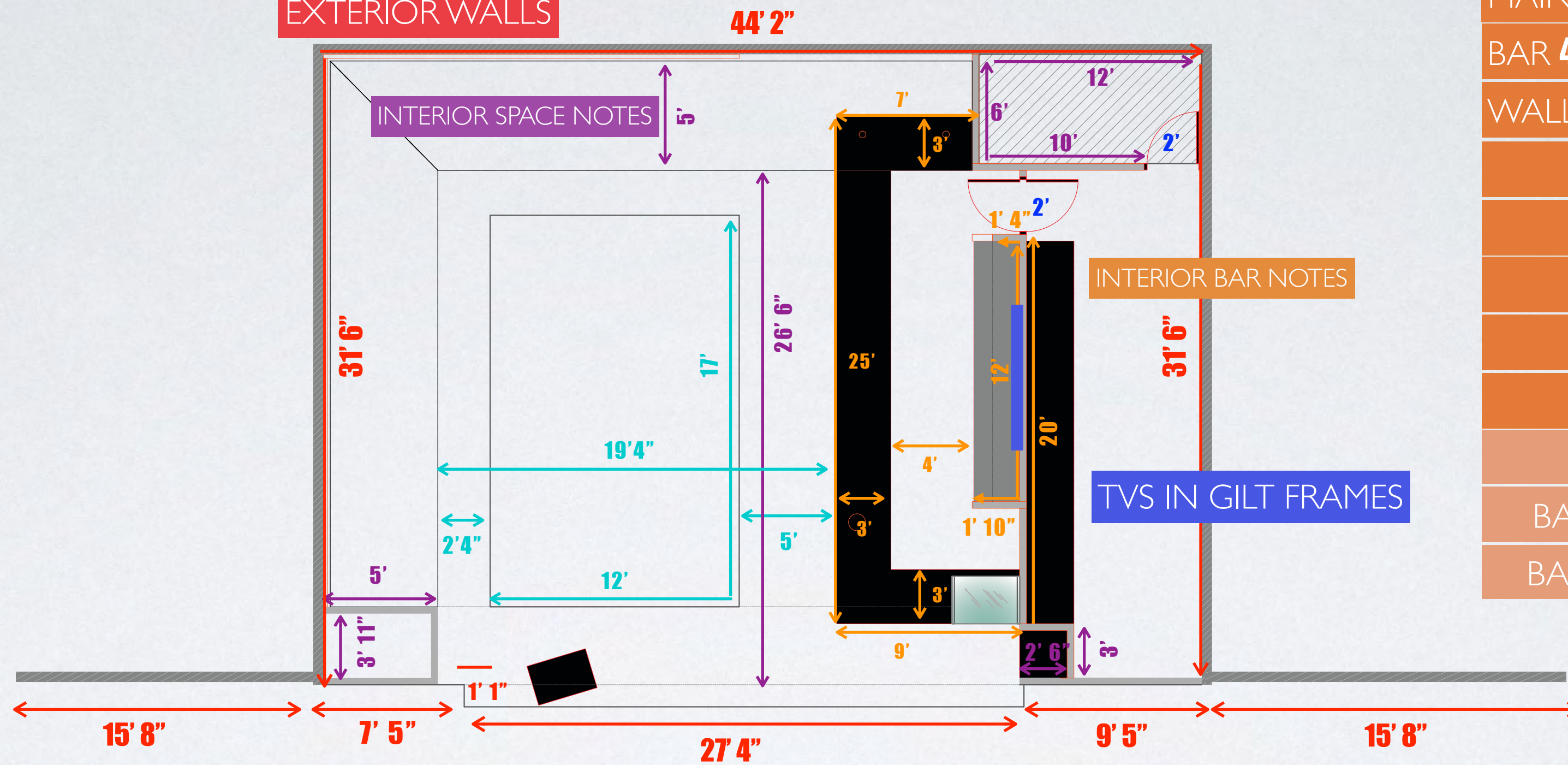

## MAIN BAR

BAR 42" h

WALLS 12' h

BAR FRONT : 25' w

BAR SIDE A : 7' w

BAR SIDE B : 9' w

BAR WIDTH : 3' w

BAR HEIGHT : 42" w

BAR BACK : 12' w

BAR BACK/SIDE A : 1' 4" w

BAR BACK/SIDE B : 1' 10" w

55" TV

## FLOATING BAR

PLATFORM 75' 8" / 10' 6" x 6" h

EXTERIOR WALLS N/A

STEP UP: 1' deep x 3" h

BACKBAR : 1' 4" w x 3" w

BACK BAR TOP : 33' w x 3" w

BAR HEIGHT : 42" w

CHARGING -A : 16' w x 4" h

CHARGING B : 3' w x 4" h

3 @ 55" TV

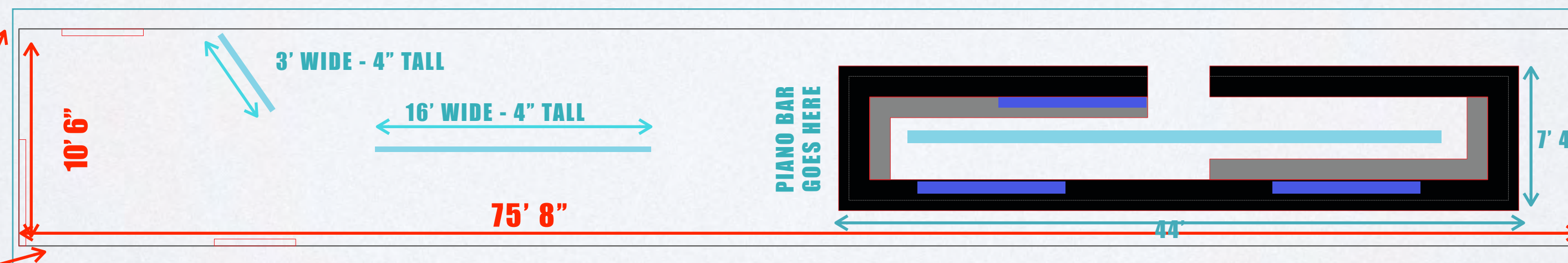

1' wide step  
3" deep

## LOUNGE AREA

BAR HEIGHT SHOULD BE 42"  
BAR DEPTH SHOULD BE 2'



FLOORING



# INTERIOR : FLOOR

THE IDEA - PROVIDE CONTRAST IN AREAS WITHOUT HEIGHT

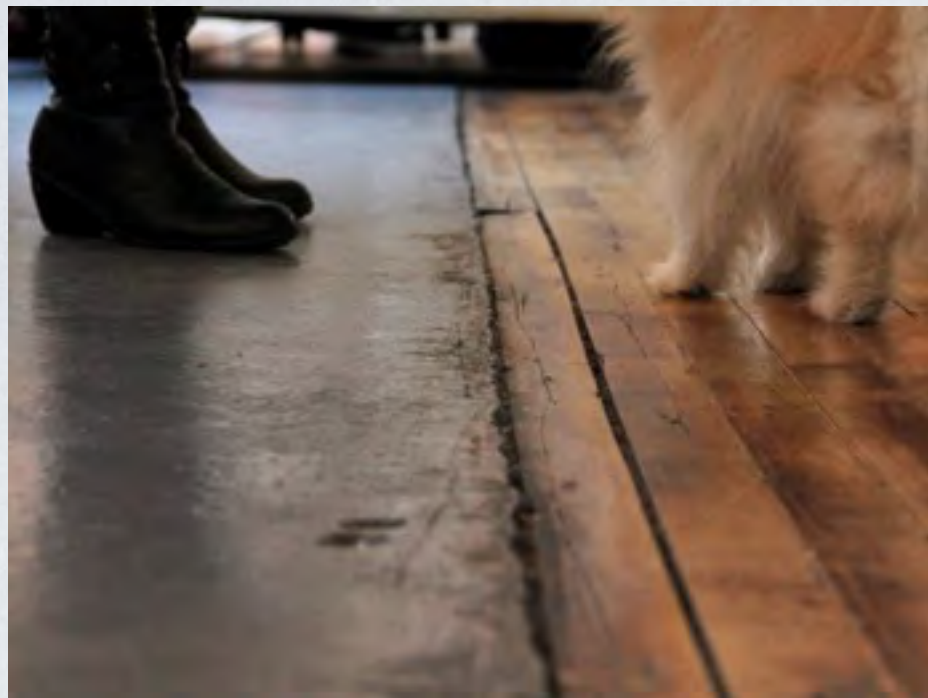

STAINED CONCRETE



WOOD FLOORING OR LVT.  
(PLANKS RUN VERTICAL INTO SPACE TO LENGTHEN IT.)  
COLOR: TBD

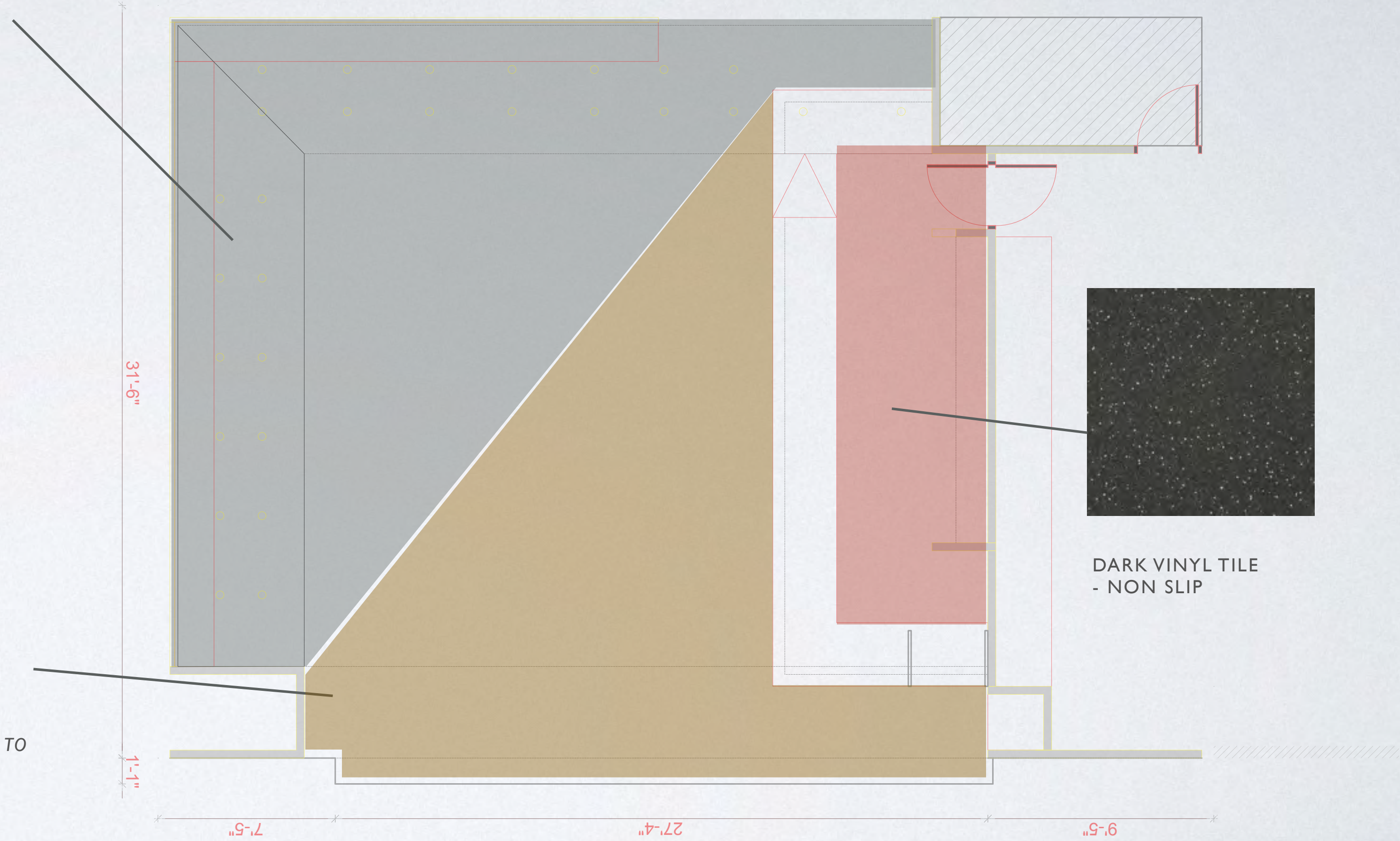

DARK VINYL TILE  
- NON SLIP



# EXTERIOR : FLOOR

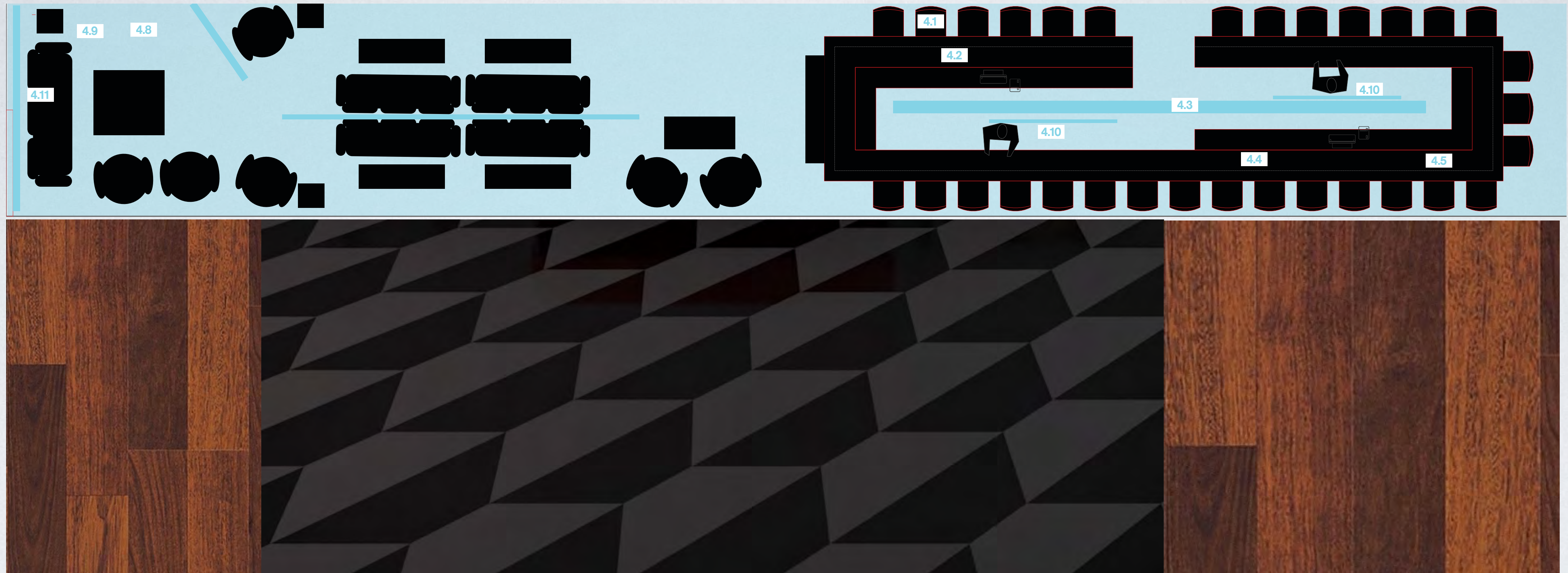



MAIN AREA



**INTERIOR : CEILING : ARCHED WARM WOOD**

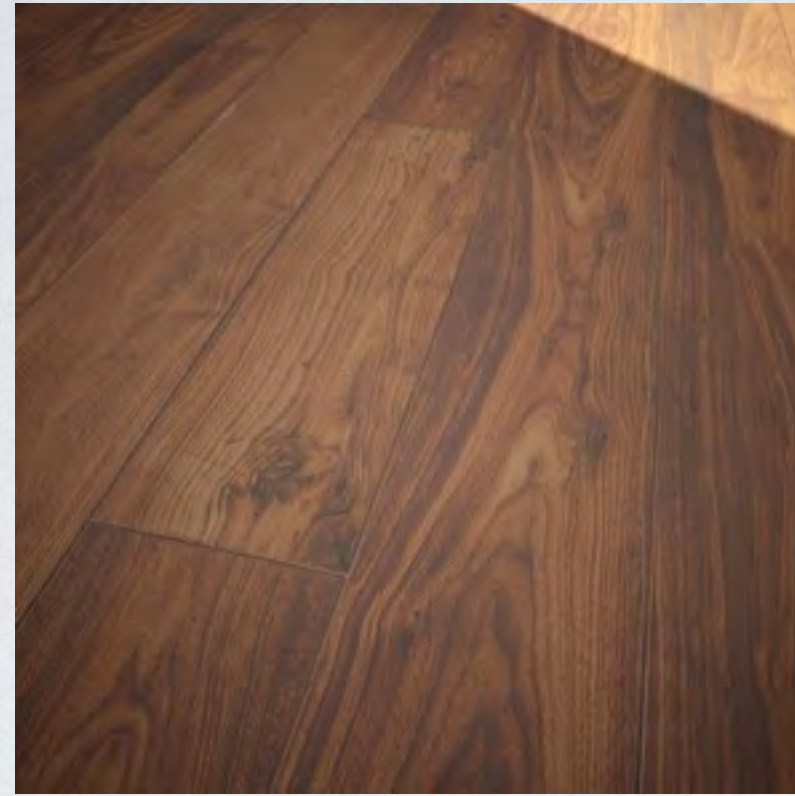

\  
BUT CHANGE COLORATION  
SLIGHTLY MORE CHERRY/GOLD

(PLANKS RUN VERTICAL INTO SPACE TO  
LENGTHEN IT.)

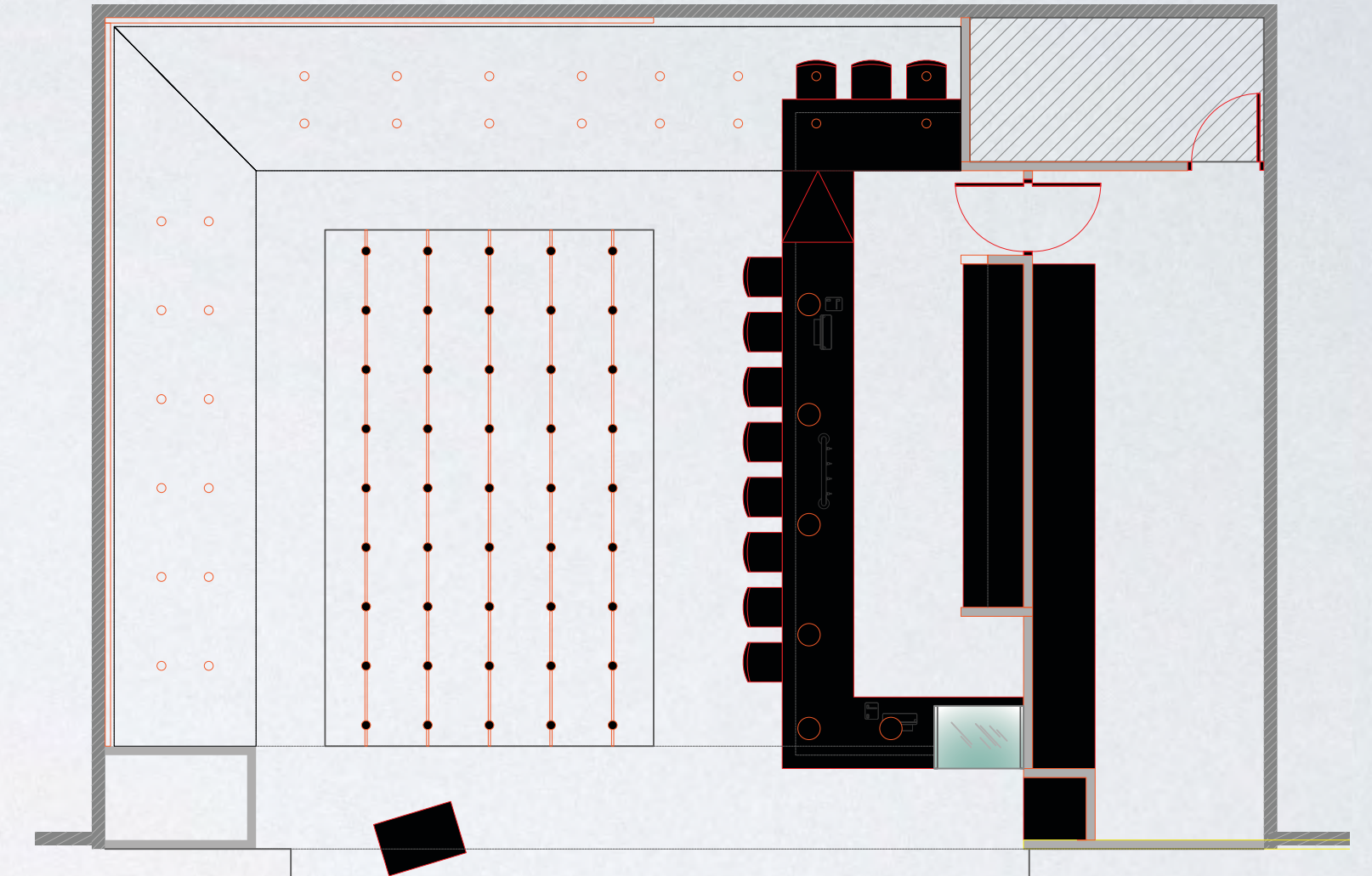



**INTERIOR : ENTRY WAY**

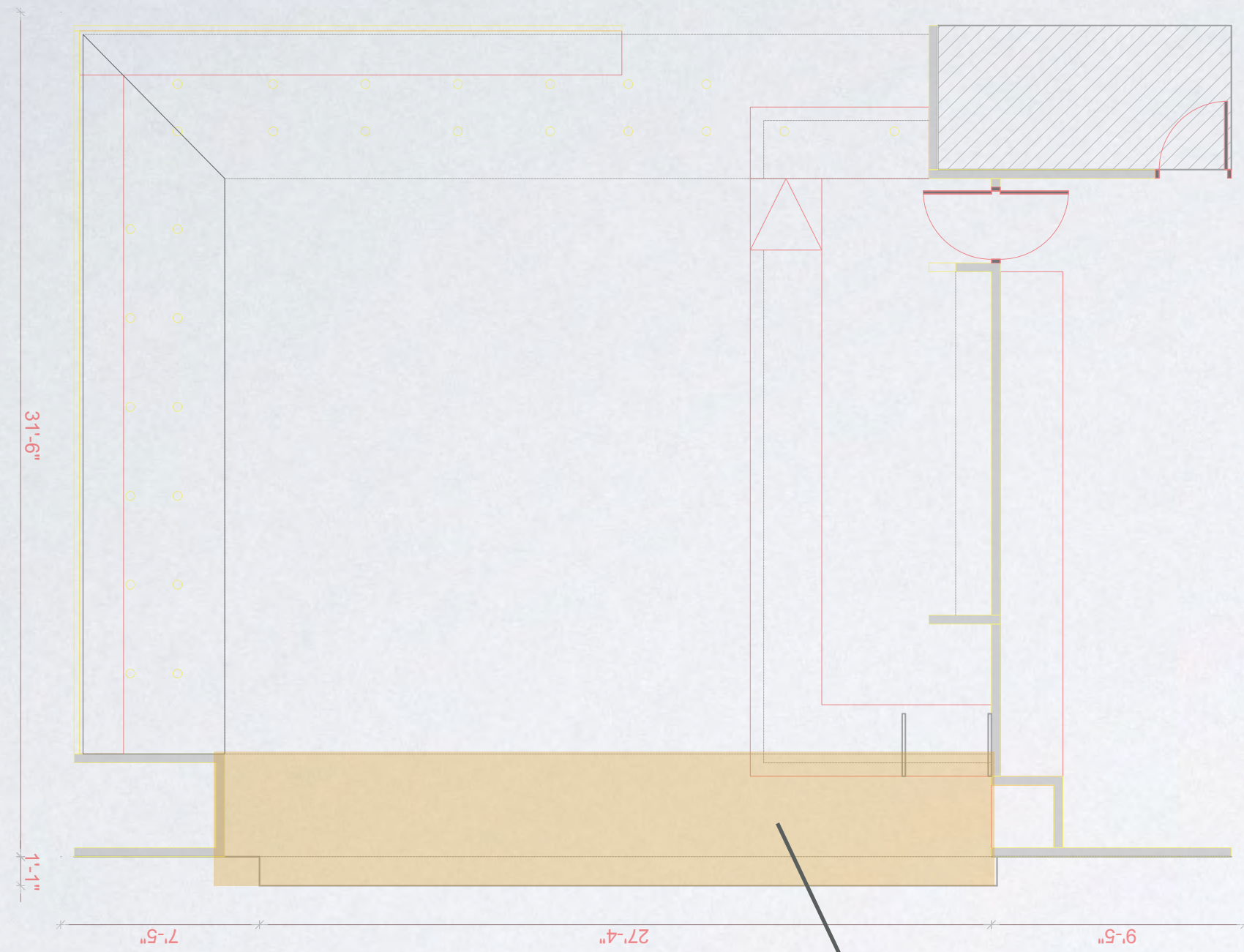

SINGLE DOME ARC - LEADING TO MAIN BAR ROOM - WOOD SUBSTRATE



**INTERIOR : WALL COVERING : PERIMETER**



EASY-TIGER-BLACK-WALLPAPER-31-172.jpg



**ART TBD**



PANELED BLACK

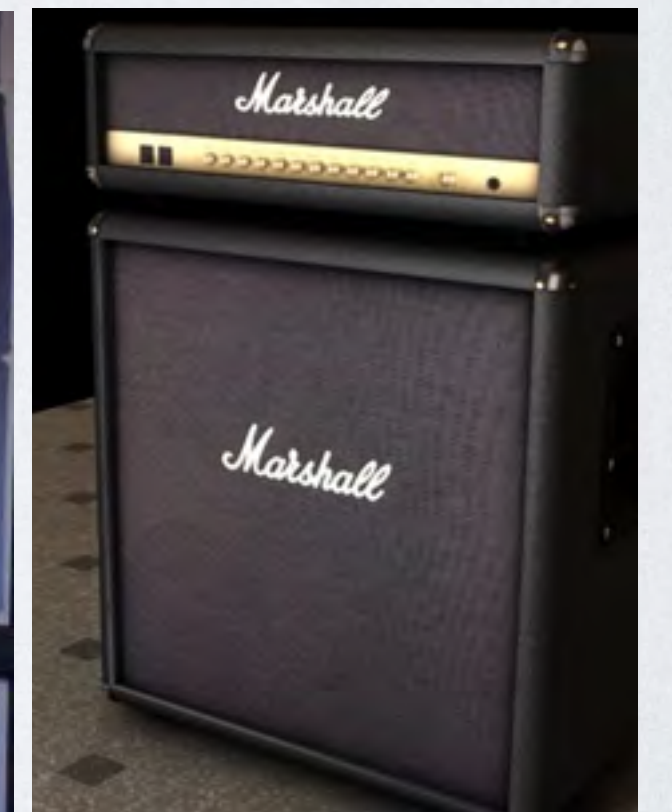

INSET ROW (OR 2 ROWS IF SPACE PERMITS OF "AMPS")



INTERIOR : EXTERIOR SURFACE

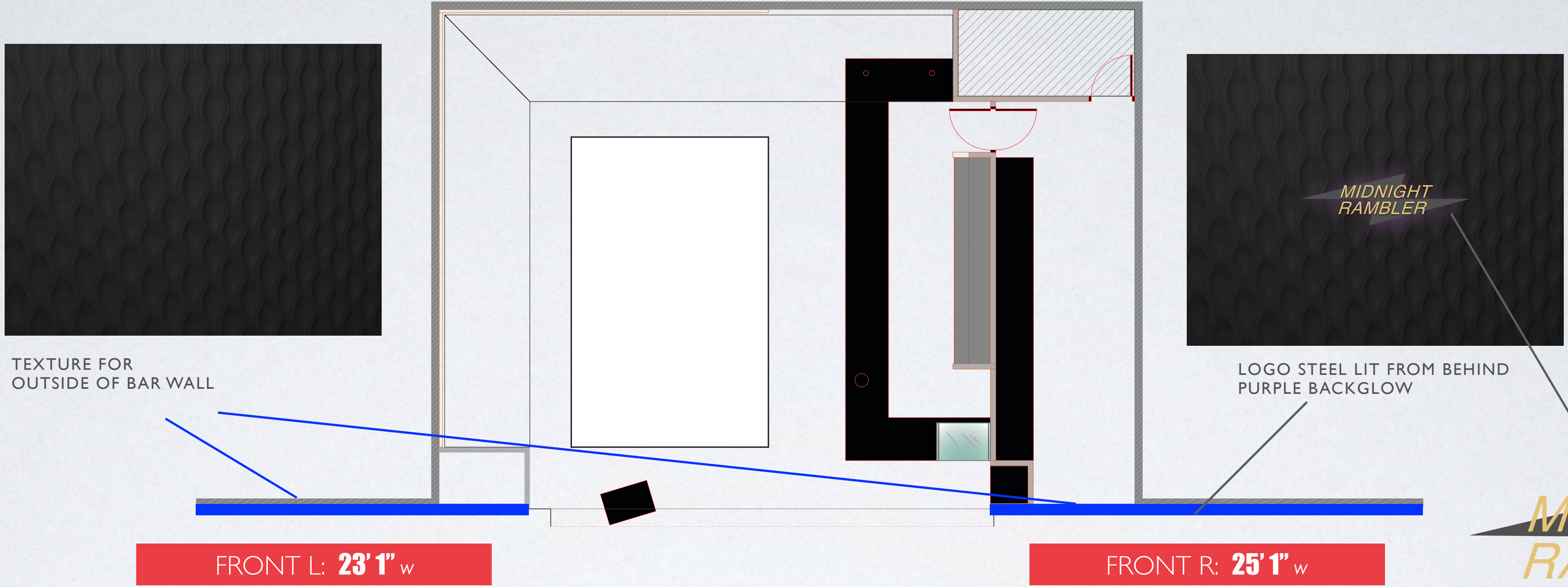



INTERIOR : PERIMETER SEATING

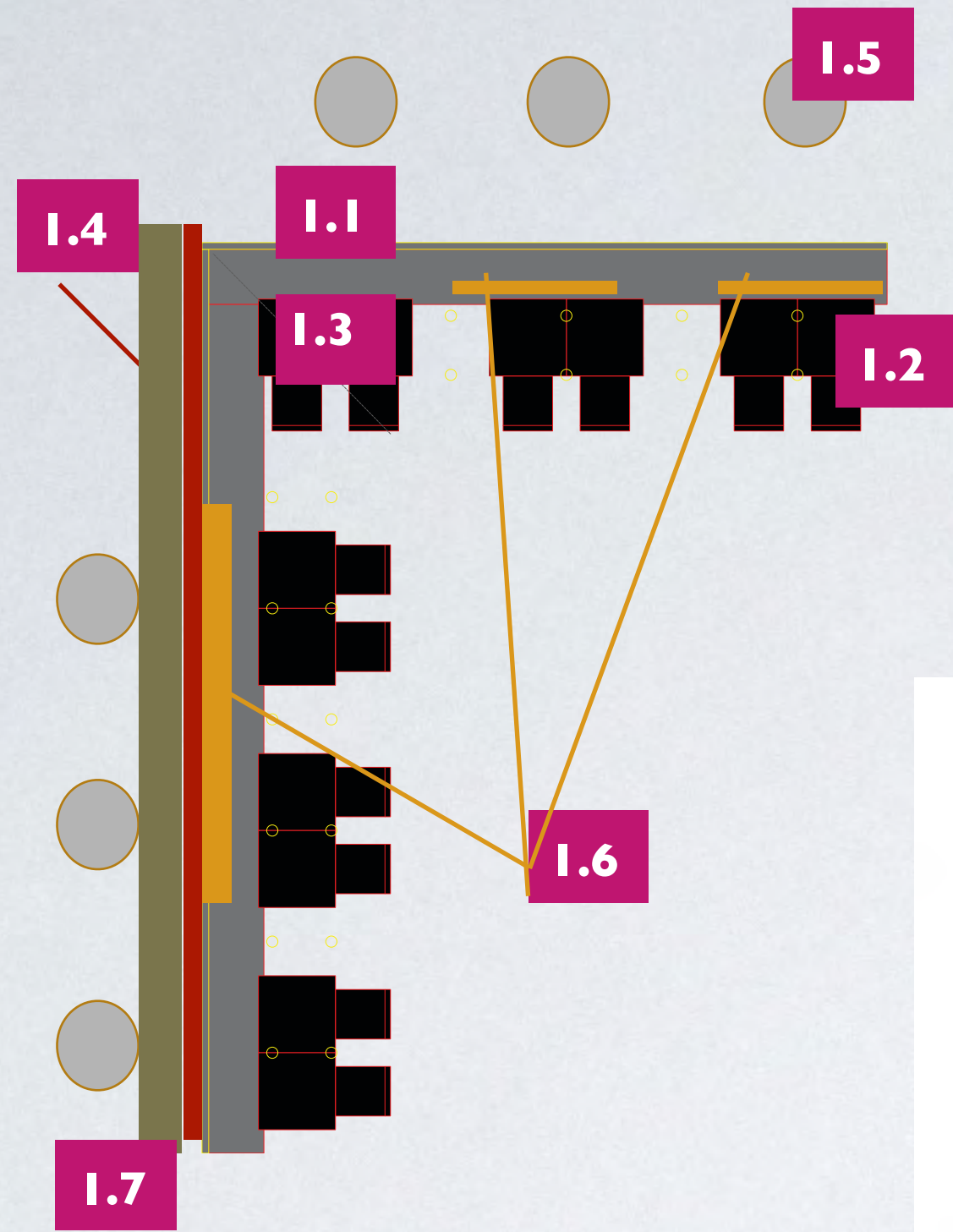

BANQUETTE-TABLES-CHAIRS.rar



CAPPELLINI\_LOUIS XV CHAIR.rar



TABLE.3DS



EDISON AURORA PENDANT LIGHT OBJ. rar



EASY-TIGER-BLACK-WALLPAPER-31-172.jpg



1.7 INSET LIGHTING ABOVE BOOTHS SHOULD BE MADE TO CREATE PATTERN ON WALL





## INTERIOR : CENTER SEATING

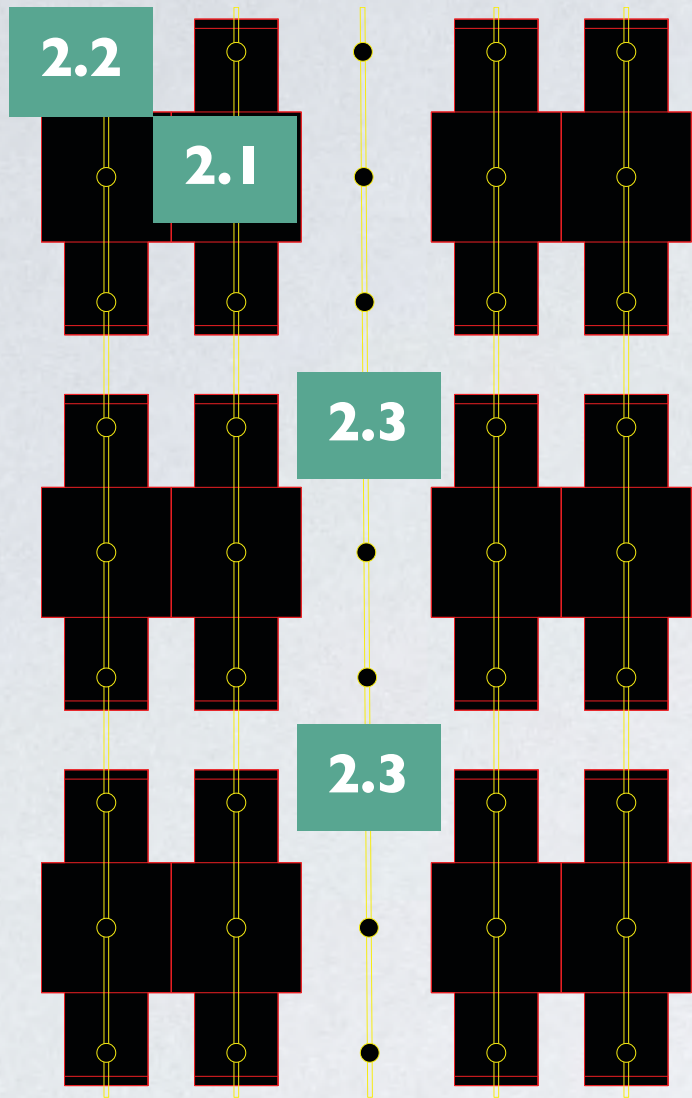

**2.4** AS NEEDED TO ILLUMINATE ROOM OR LOOK COOL.

2.1



CLASSICTABLES.3DS

2.2

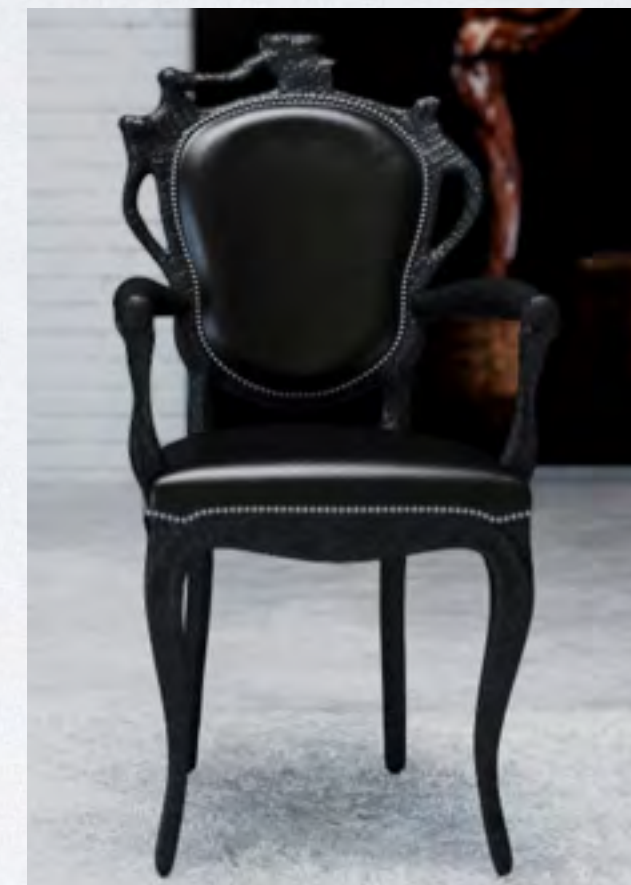

MOOI SMOCK DINING.zip

2.3



ROLL & HILL MODO CHANDELIER - 3 SIDED\_OBJ.rar

2.4

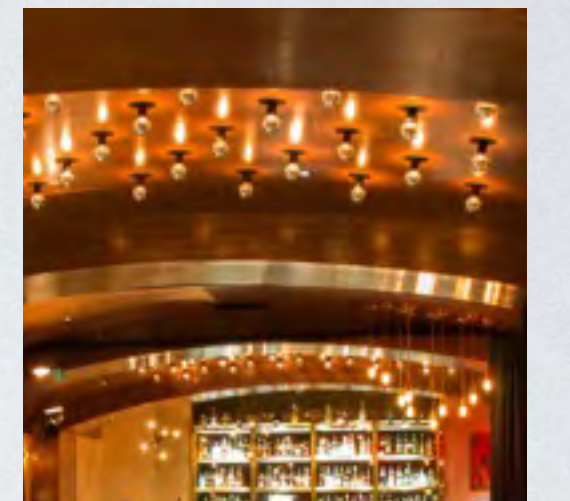

INSET SINGLE BULB LIGHTING



**INTERIOR : BAR SEATING**

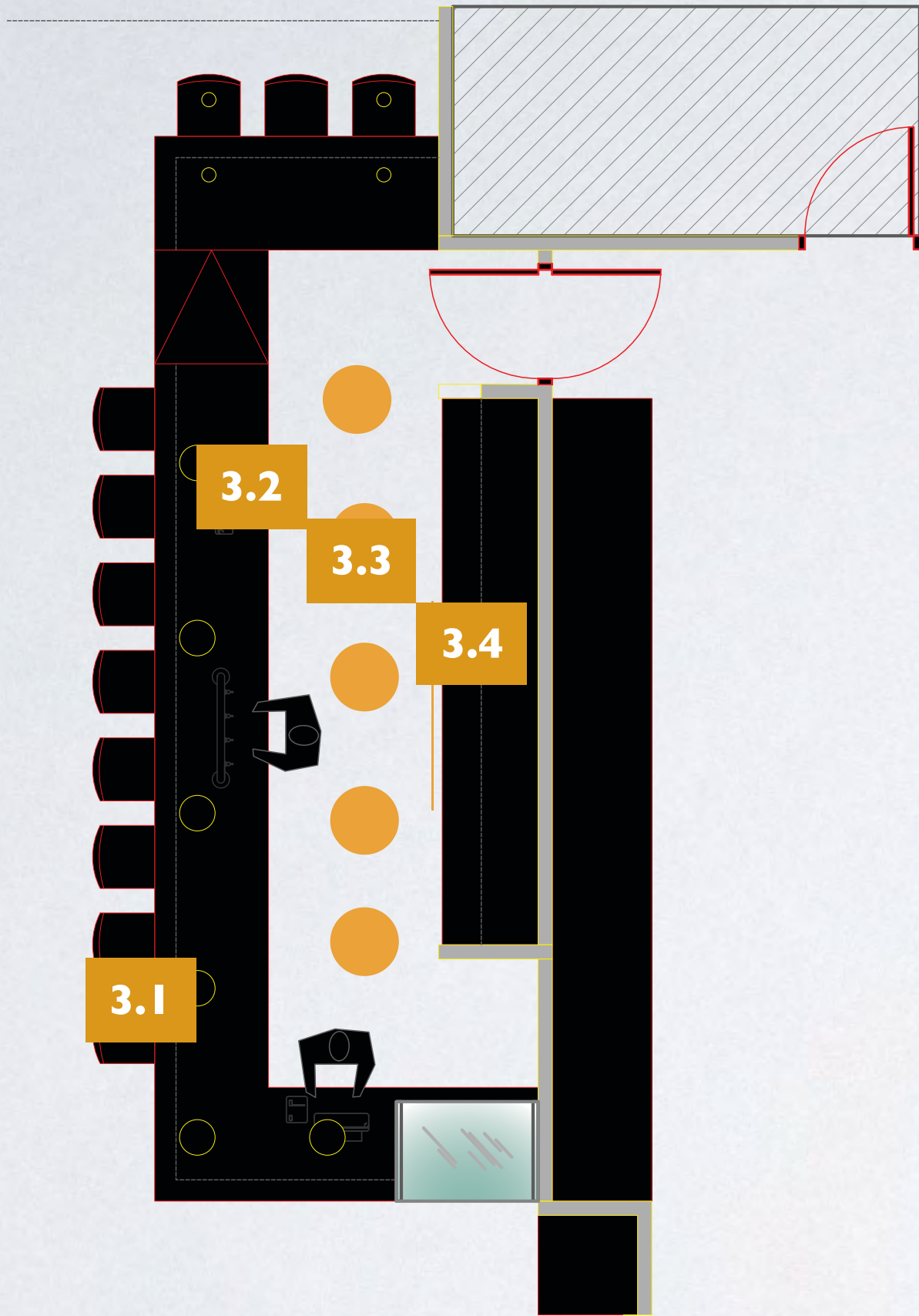

3.1



LAPALMA\_MIUNN.3DS



BAR STOOLS SHOULD HAVE CUSHIONS IN THESE COLORS

3.2



CGAXIS\_MODELS\_31\_10\_MENTALRAY.ZIP

3.4

3.3



TOMDIXON\_BEATLIGHTS\_3DS.zip



HOLLY HUNT LIGHTING BELL JAR.rar



**INTERIOR : BARFRONT**

TOP GLASS WITH INSET OF REPEATING SERIES OF MODERN TURNTABLES MOUNTED UNDER IT. FOR A SECTION.



STEEL AND WOOD BASED BAR VISUAL LOOK.

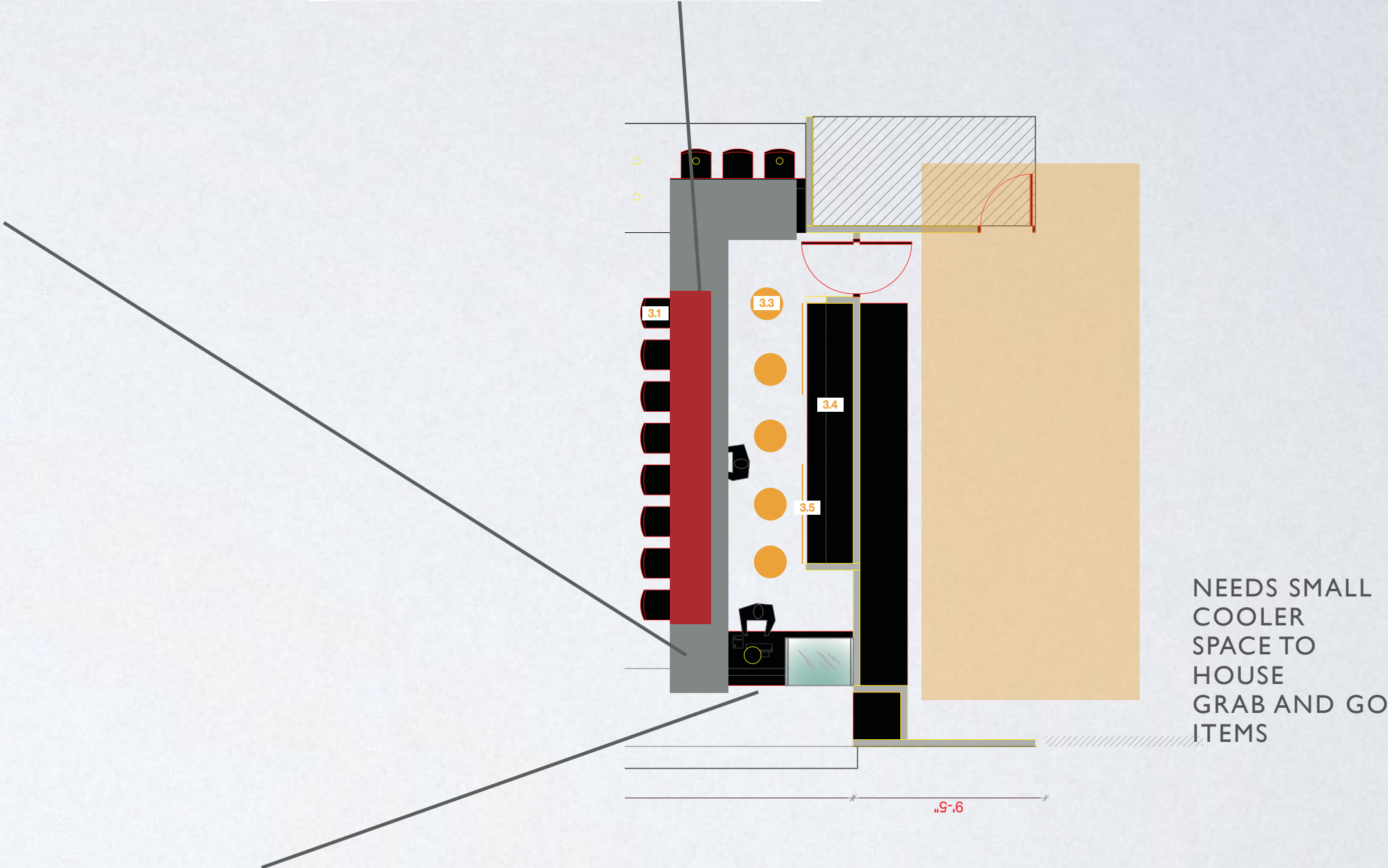

SIMILAR CONSTRUCTION BUT LOWER HEIGHT WITH SIDE REFRIGERATED AREA FOR GRAB AND GO.



\*\* POSSIBLE BASE RENDER (WOULD NEED TO MATCH ABOVE) - I CAN DO A DETAIL TEMPLATE IF YOU NEED (TOP ONE WAS A SCREENSHOT FROM A RENDER IN ARCHINTERIORS but I can't find it.



**INTERIOR : BACK OF BAR**

MIRRORED  
WALL IN  
DIAMOND  
PATTERN



BIG SCREEN TV  
- MOUNTED IN  
GOLD GILT  
FRAME

SHORT 3 TIERS  
TO SIT BOTTLES  
ON



IS THERE A WAY  
TO INTEGRATE  
THIS? NOT  
SURE RIGHT  
NOW BUT KEEP  
IT IN MIND.



**INTERIOR : BAR LIGHTING**



**BELL JAR**  
4.5DIA x 10H



# INTERIOR : SPECIALTY LIGHTING : CENTER SEATING

MODERN CHANDELIER RUNS CENTRALLY BETWEEN TABLES AND CENTERED IN CEILING.

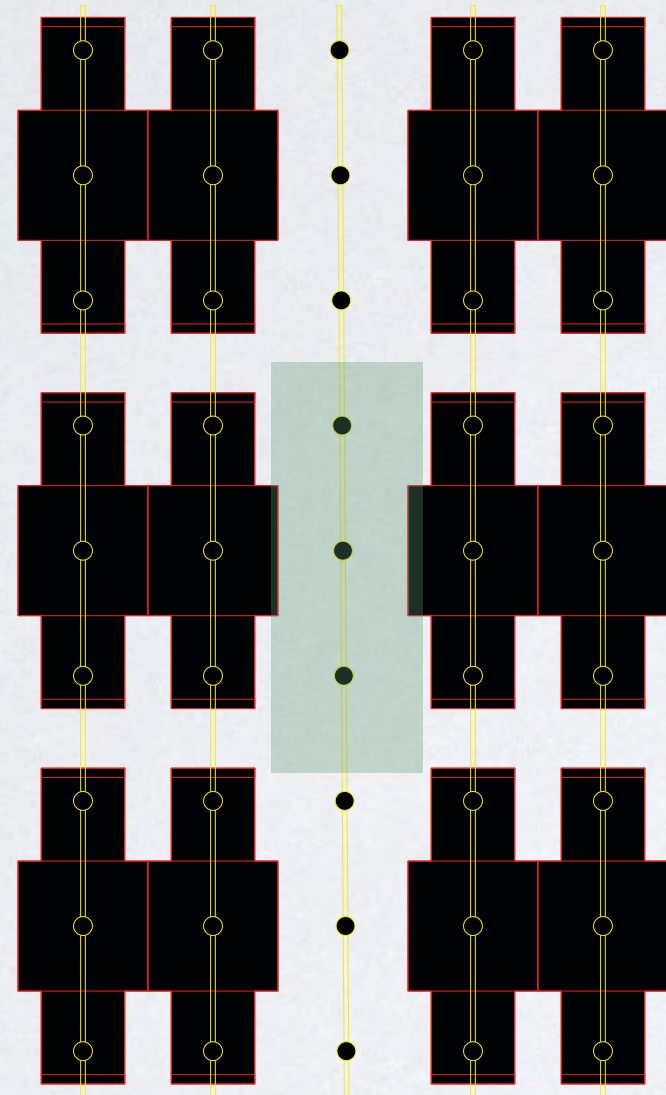

\*\*

CHANDELIER B (MAYBE USE TO BUILD)



## INTERIOR : GRAB AND GO

SIDE OF BAR  
COUNTERTOP  
SHOULD BE ALL  
STAINLESS (A  
CARRYOVER  
FROM BAR ON  
FRONT AND BE  
SLIGHTLY  
LOWER IN  
HEIGHT.

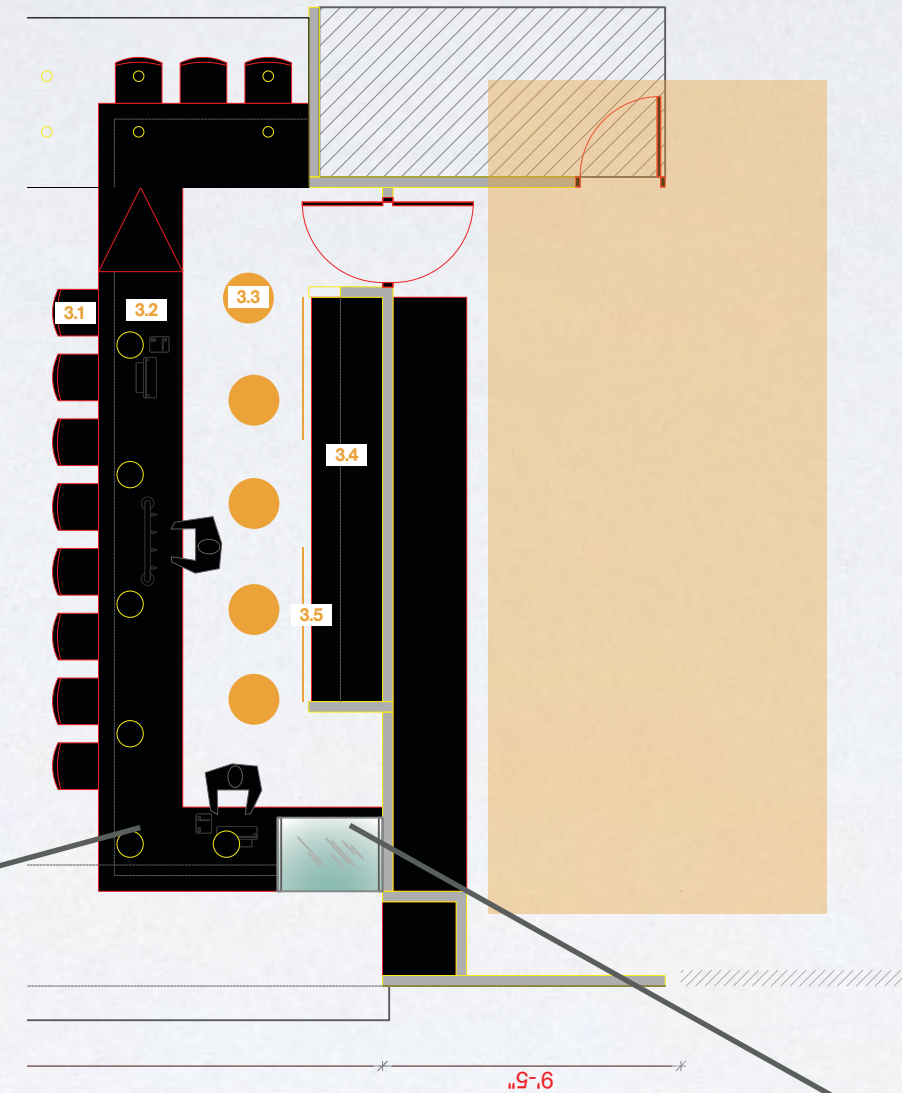

GRAB AND GO  
COOLER CASE!  
(ALSO FROM  
TURBOSQUID!)



FLOATING BAR



# FLOATING BAR : LAYOUT

WALKWAY FROM FRONT OF BAR TO FLOATING AREA - (SUBSTRATE WOOD)

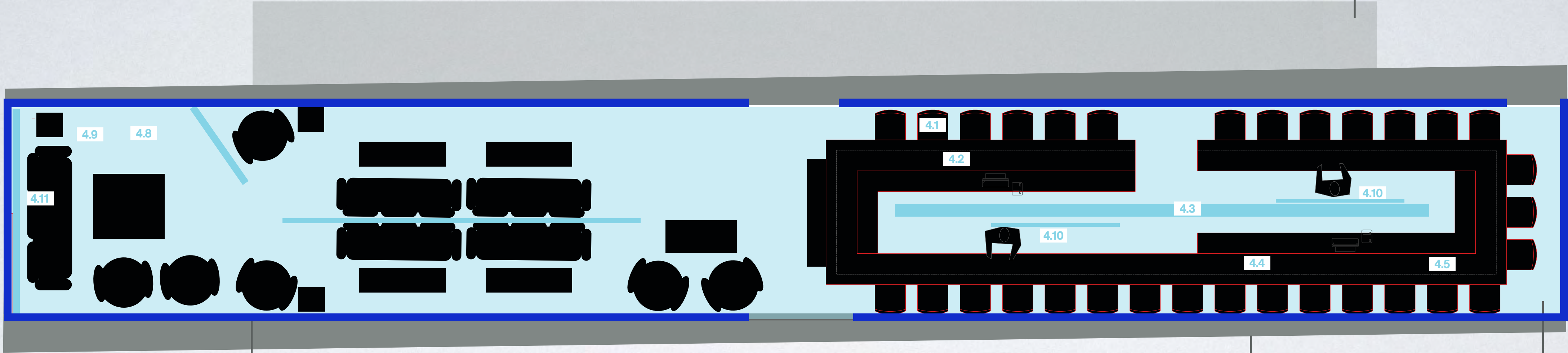

**SHORT RAILING**  
(SUBSTRATE WOOD TOP  
- PIANO BLACK SIDES)



**STEP UP 3 INCHES**  
(SUBSTRATE WOOD TOP  
- PIANO BLACK SIDES)



**TOP LEVEL 6 INCHES**  
(SUBSTRATE WOOD  
PLANK RUNS VERTICAL)





## FLOATING BAR : CEILING



CEILING OVER LOUNGE  
ORAGAMI OVERLAPPING PANELS -  
SUBSTRATE BRONZY GOLD MATERIAL  
OR MAYBE MIRRORS...THAT RUN THE  
LENGTH OF THE FLOATING BAR.

SOMETHING SIMILAR TO THIS BUT  
NOT THIS DEEP OR HEAVY - WANT IT  
TO LOOK LIKE IT OVERLAPS AND  
HAS SHALLOW DEPTH.



CHANDELIER OF SOME  
SORT GOES IN BETWEEN  
RECORD WALL I NEED TO  
KNOW HOW MUCH  
CLEARANCE WE HAVE  
AFTER WE BUILD THE BAR  
TOP... WE MAY NOT NEED  
A CHANDELIER...

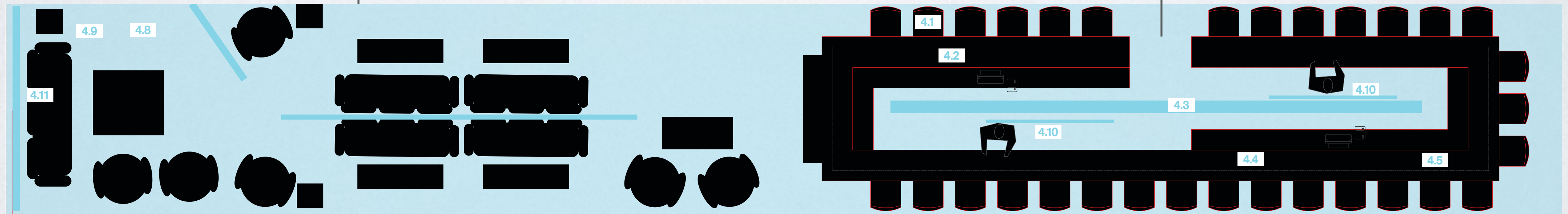



# FLOATING BAR : BAR AREA

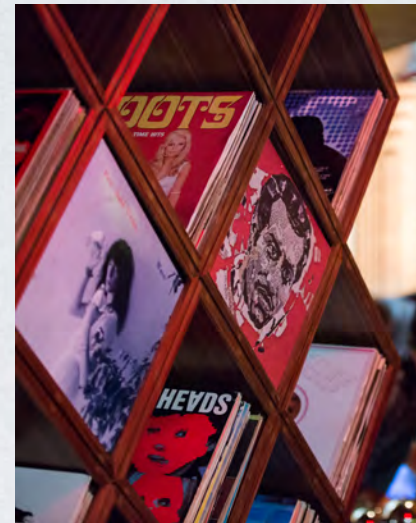

WOODEN RECORD HOLDERS, SOME ARE VERTICAL SOME FILL THE SPACE. THESE COULD HANG TOO. THIS SHOULD PROBABLY BE A DOUBLE ROW AND BUILD OUT IN ALL FOUR DIRECTIONS (IN THE ROUND)

GOLD FRAMED TV LIKE ON INTERIOR

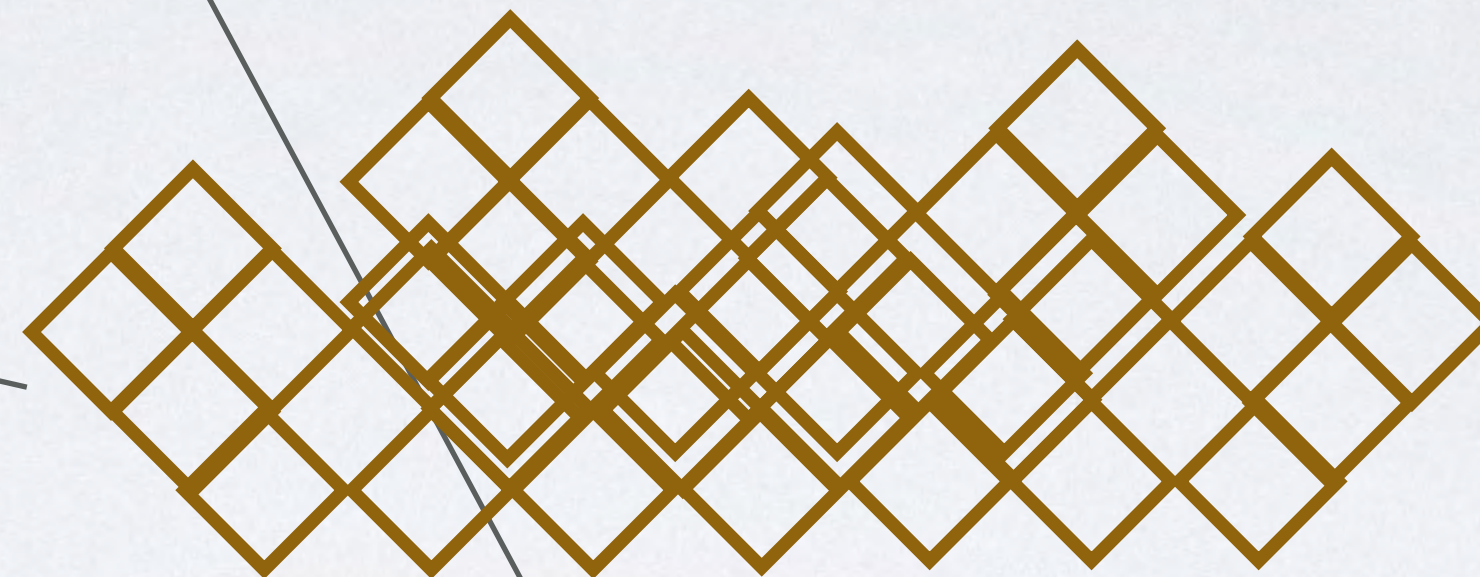

FLAT MIRRORS

SHELVES FOR BOTTLES

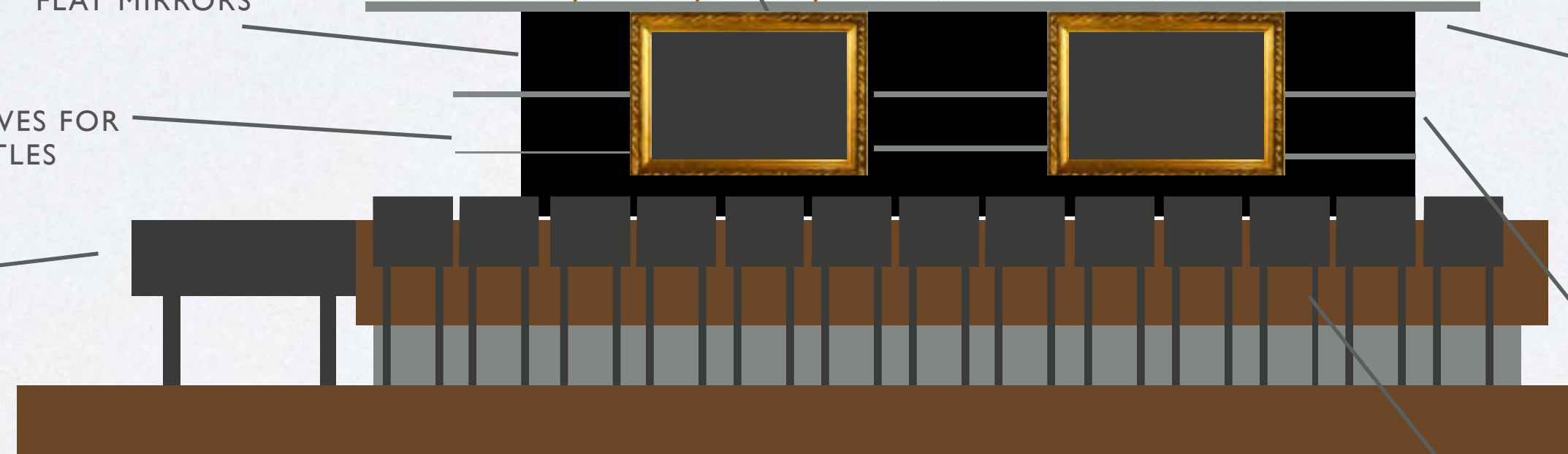

BRONZE CYMBALS UNDER OVERHANG SINGLE BULB LIGHTING

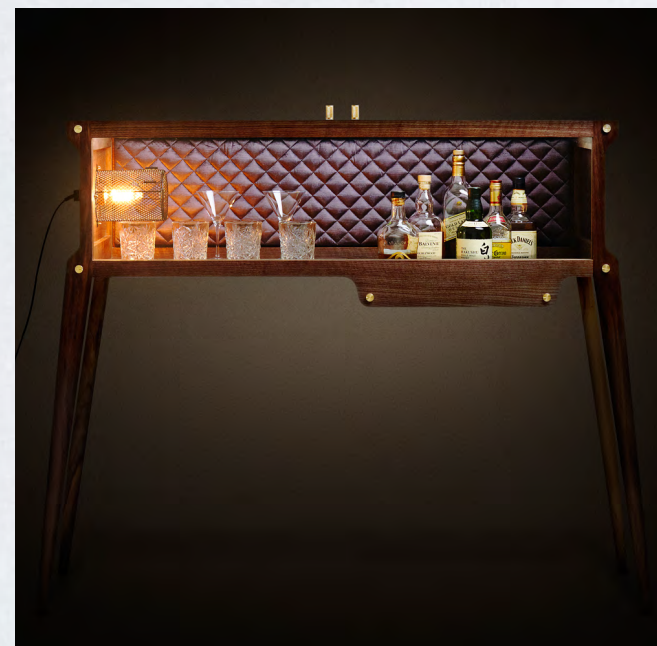

CONVERTED "PIANO BAR" MADE OF A BABY GRAND PIANO (MAY HAVE TO BE AN UPRIGHT IF WE CAN'T FIGURE OUT) - NO SEATING AROUND THIS AREA. THIS WOULD BE A MIXOLOGY BAR. SO NEEDS TO HAVE ATMOSPHERE.

- NOT SURE HOW THIS WOULD WORK - IDEAS???

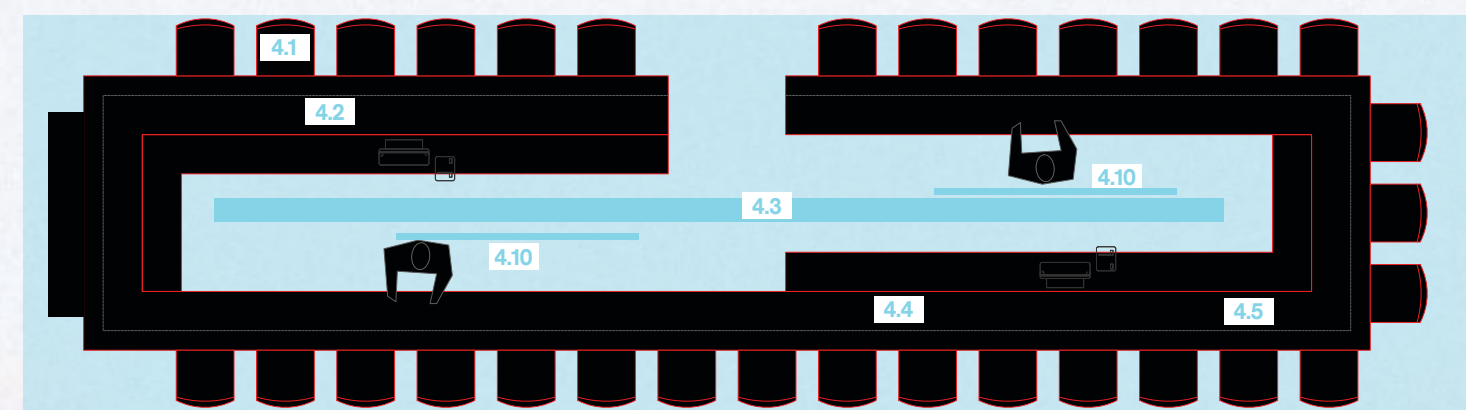

BAR AND BARSTOOLS CAN MINIMIC INTERIOR



COCKTAIL SIGN AT END OF BAR.



## FLOATING BAR : PIANO BAR PIECE

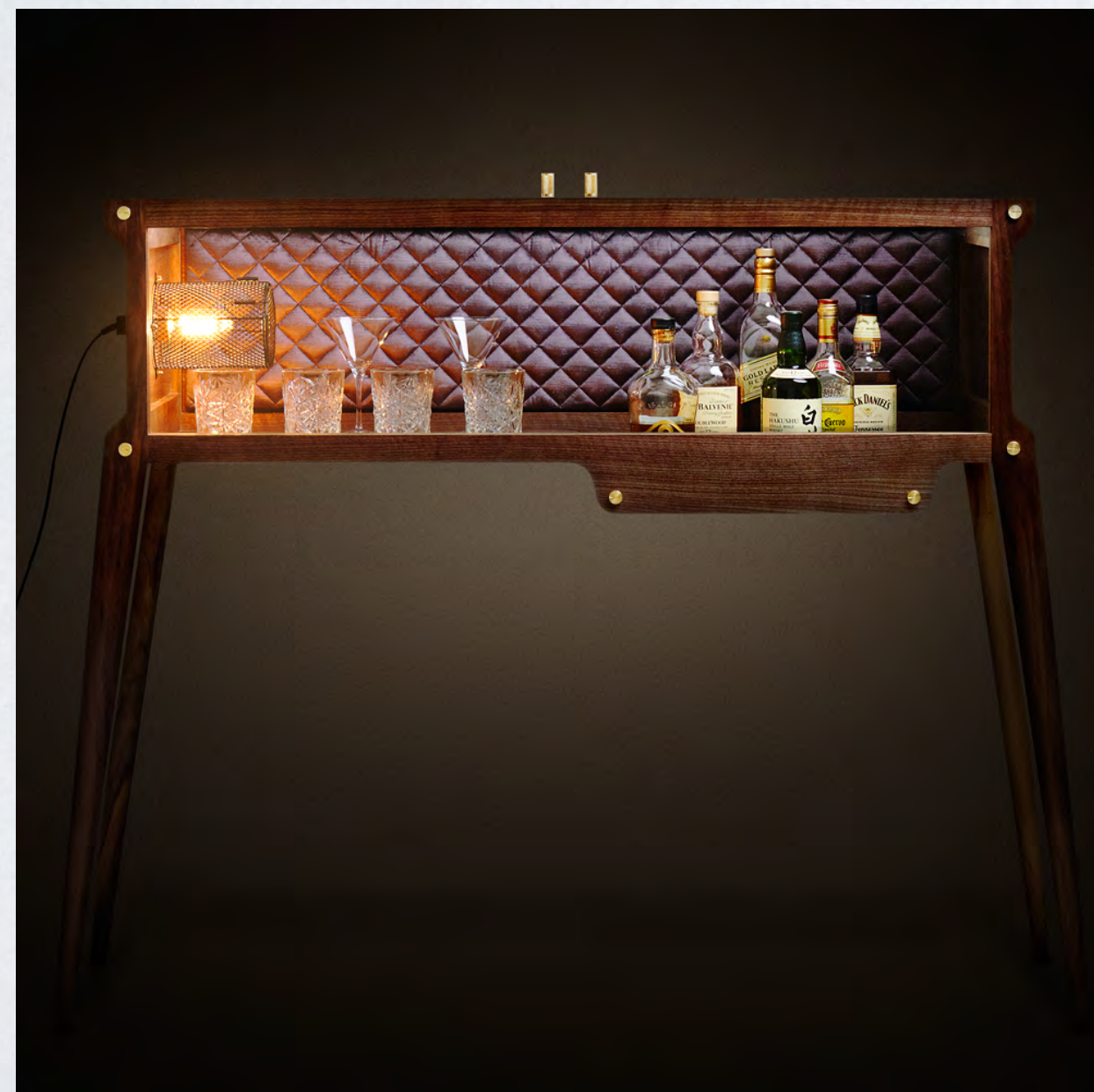
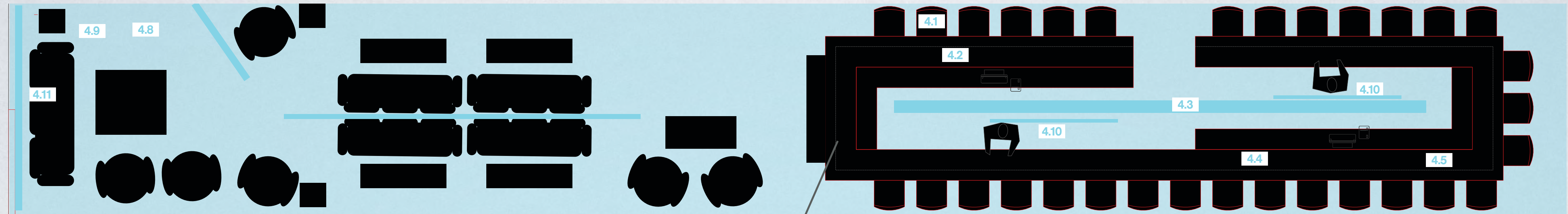

CONVERT THIS A BAR A SO MAY NEED TO BE TALLER TO BE A BAR HEIGHT - LOSE THE KEYBOARD.. EXTEND TOP OF KEYBOARD AREA UPWARD AND MAKE IT A SHADOW BOX... LIKE ONE ON LEFT.

I WOULD LIKE A WOOD EDGED WITH PIANO BLACK FINISH THO. IT'S COOL. - NO STEEL LEGS MAKE THOSE THE WARM WOOD.

MAKE A FLAP ON TOP THAT IS ONLY HALF THE PIANO SO IT CAN FLIP OVER OUTWARDS FOR GUESTS TO GATHER AROUND - SHOW HINGES ON RIGHT SIDE SO -BARTENDER CAN WALK BEHIND.





## FLOATING BAR : LOUNGE AREA WALLS

THIN WALLS WITH ONE SIDE  
WHITE ONE SIDE BLACK GLASS  
MOUNTED TO THEM - LEAVING  
ROOM FOR A WIRES/PLUG INS/  
CHARGING STATION BEHIND.

LIGHTNING BOLT SCREENED  
VERY LIGHTLY FROSTED FROSTED  
ON EACH SIDE.

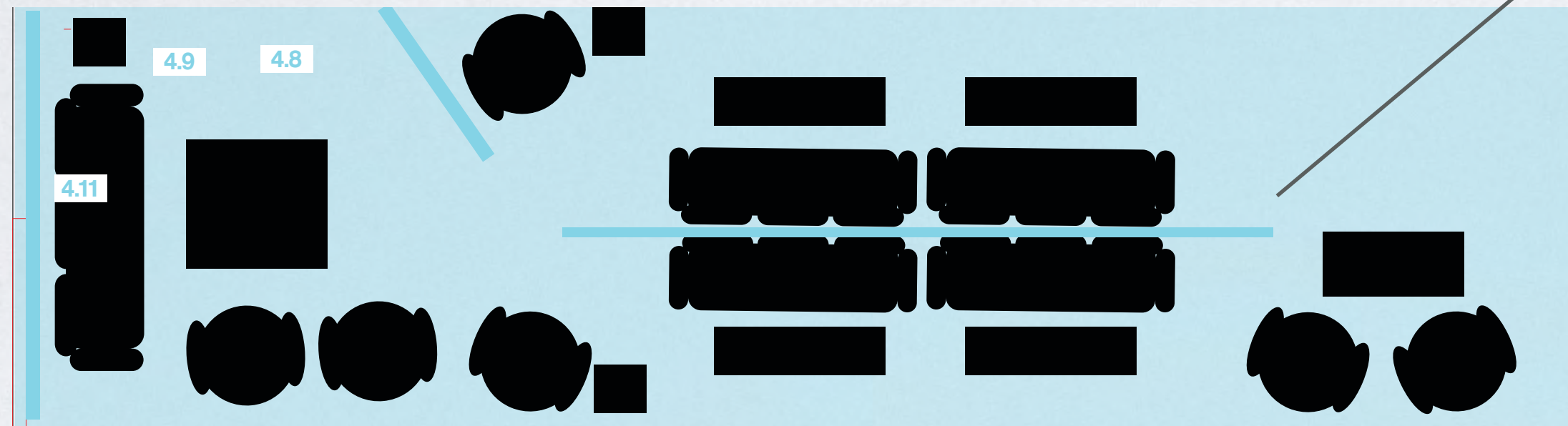

WITH CHARGING  
STATIONS BUILT IN VIA  
CUBBY HOLES.

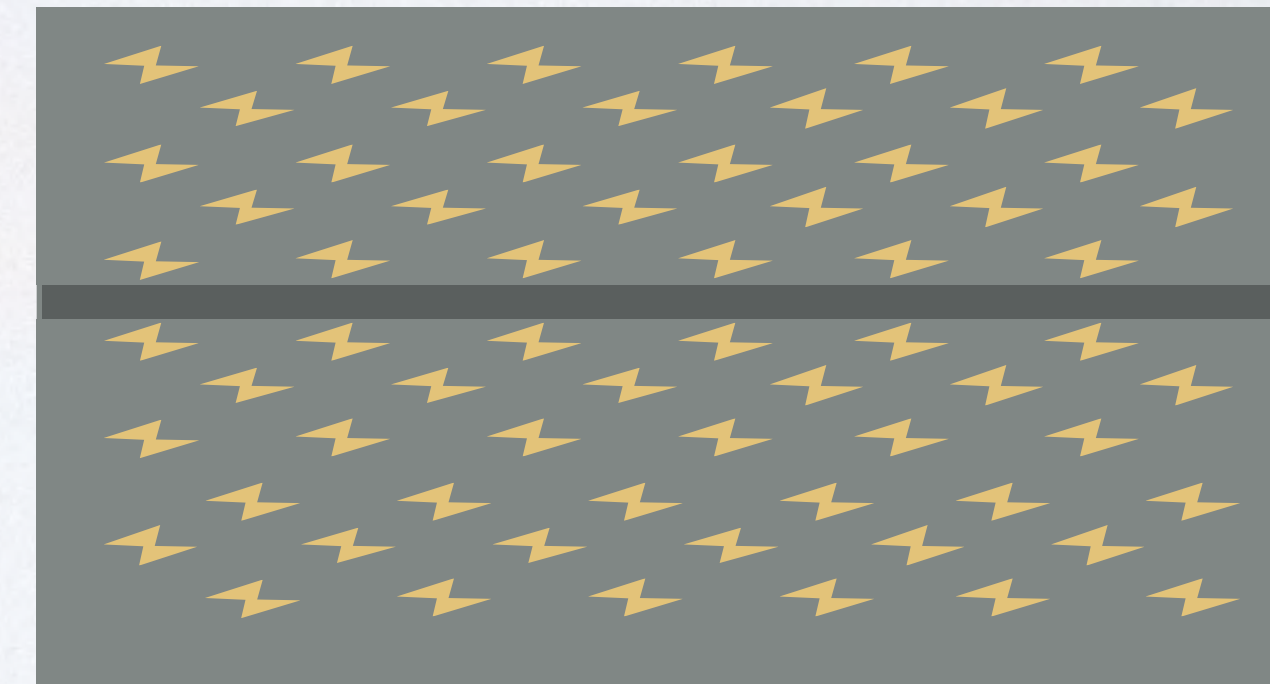



# FLOATING BAR : GLASS WALLS



SIDE ONE WHITE WITH GLASS

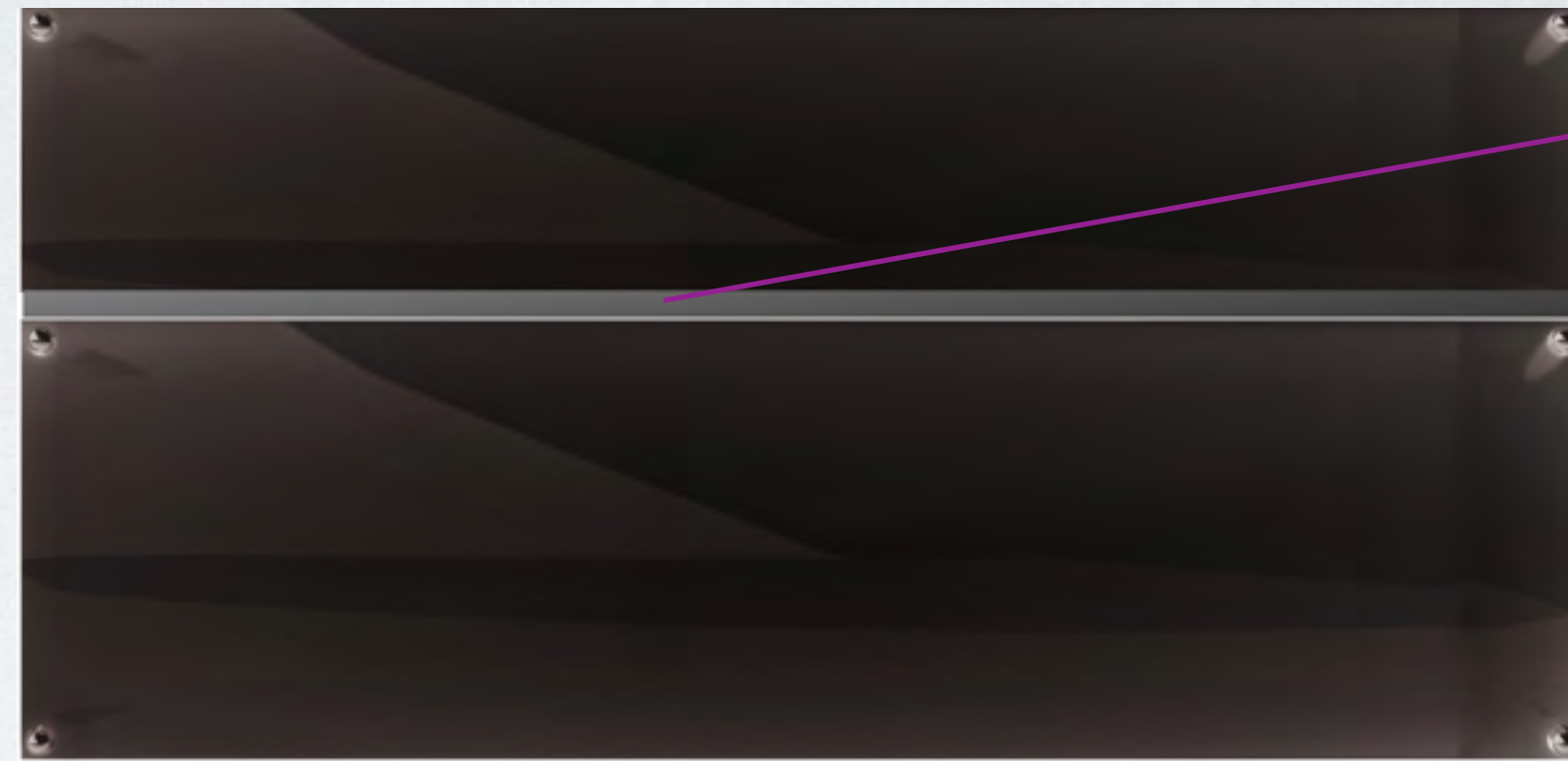

SIDE 2 BLACK WITH GLASS

CUBBY AREA FOR CHARGING OUTLETS AND PHONES

JUST WHITE WALL WITH GLASS WILL HAVE TV OR ART ON SIDE FACING SOFA

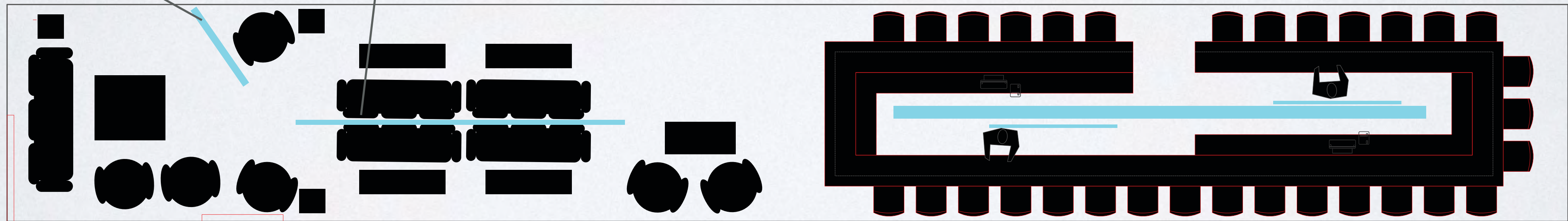



**EXTERIOR : FLOATING BAR SEATING RIGHT**

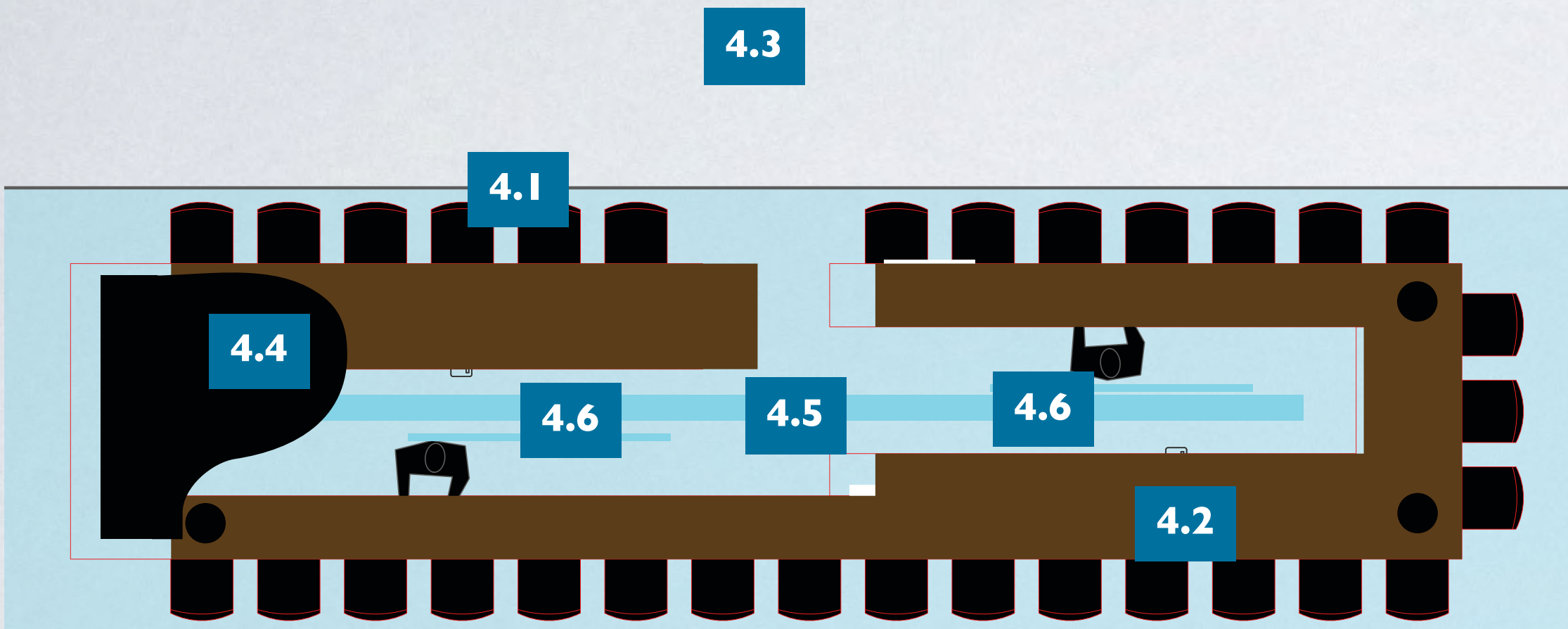

BAR STOOLS SHOULD HAVE CUSHIONS IN THESE COLORS

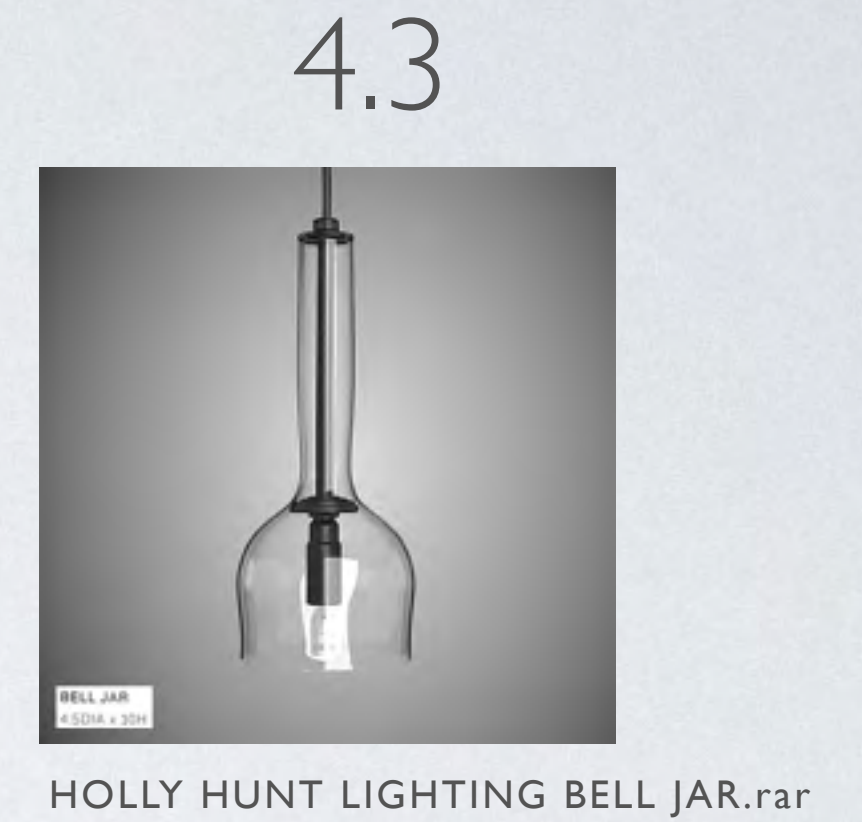

CUBBIES OVER BACKBAR SHOULD HAVE WINE, RECORDS AND RECORD FRONTS IN THEM

4.4



MODIFIED SEE PAGE 32

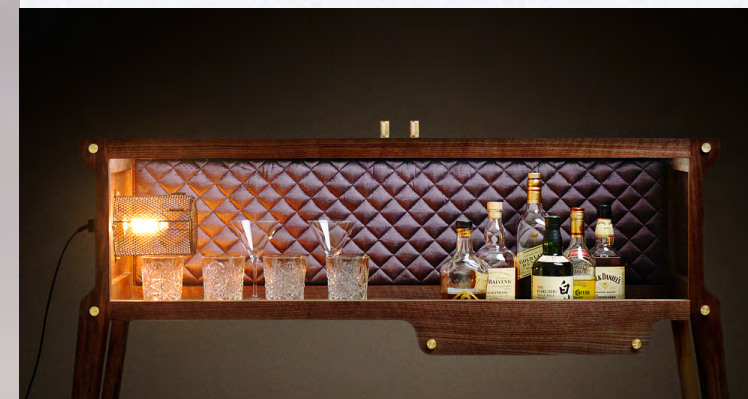

4.5

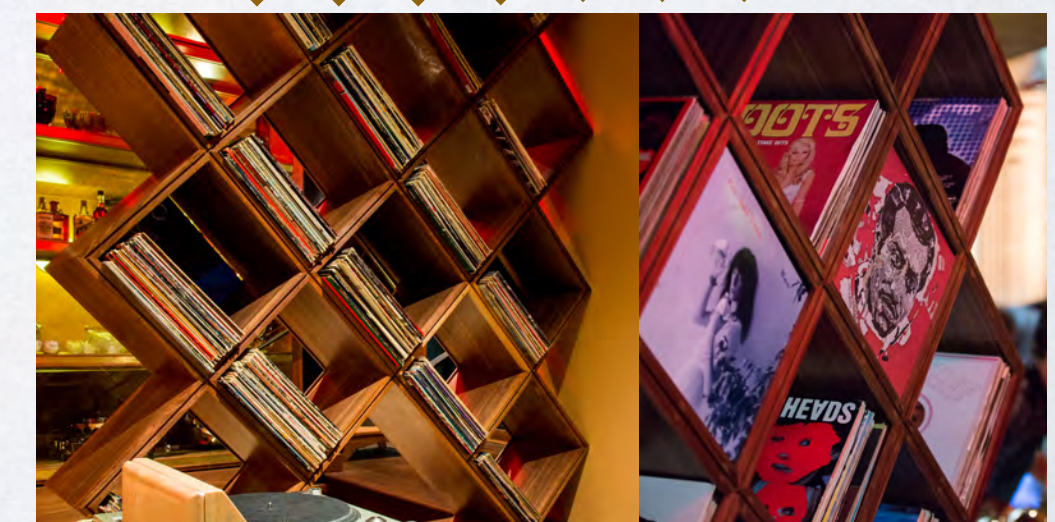
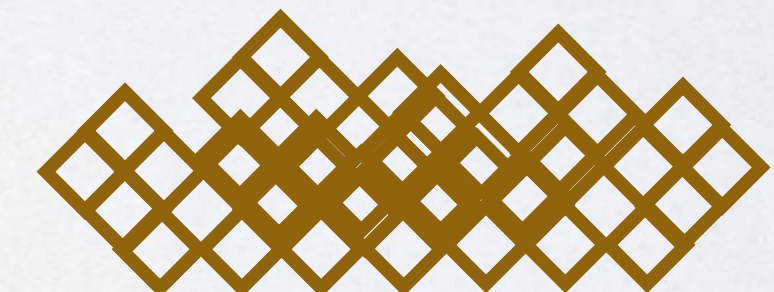



4.23

EXTERIOR : FLOATING BAR SEATING LEFT

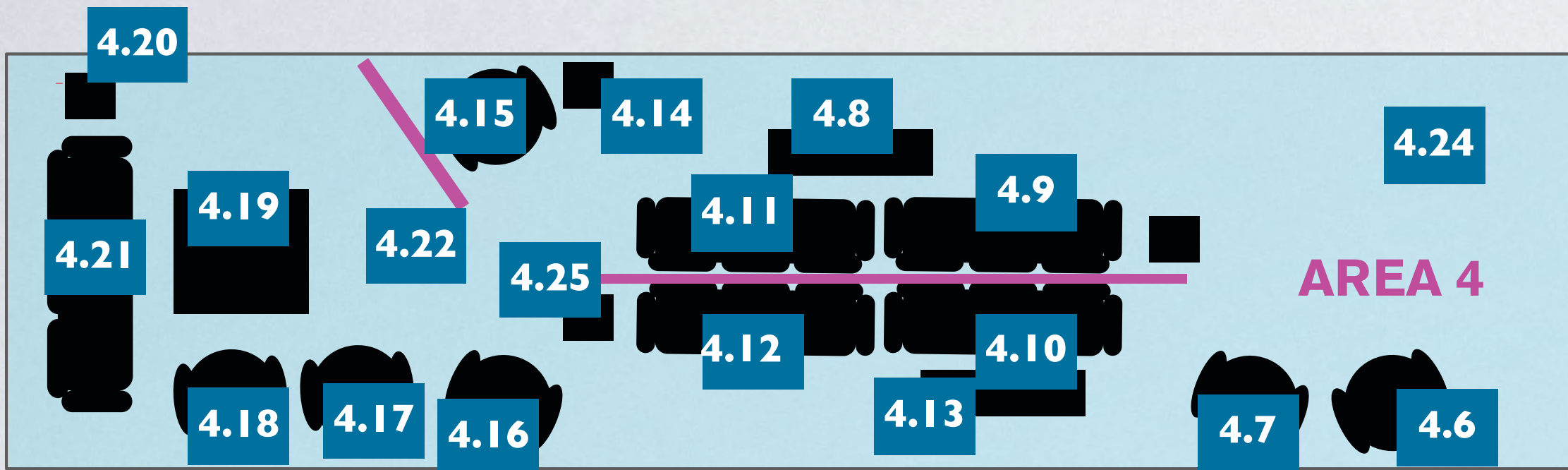

4.6  
2010 TUFTED WING CHAIR 1231-18.rar



4.7  
163123.zip

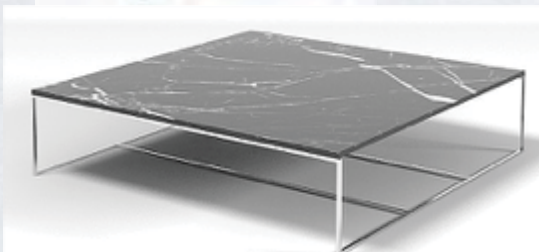

4.8  
MINOTTI 142.rar



4.9  
MANTELLASSI.MAX.rar



4.10  
ZANABONI SOFA- MILLENIUM.rar



4.11  
SOFA CRAWFORD.rar



4.12  
BLACK LUCREZIA SOFA\_3DS.rar



4.13  
SM\_COFFEETABLE\_005\_MR.max

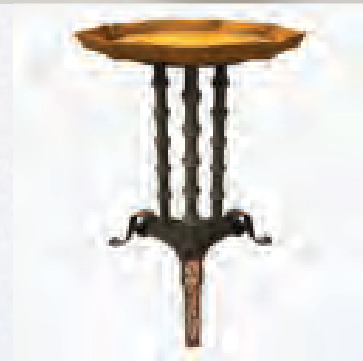

4.14  
PIE\_TABLE.3DS



4.15  
PROGETTI.3DS



4.16  
mars chair.rar.



4.17  
6134C-1.zip



4.18  
PPI9max.zip



4.19  
TABLE WOOD SLICE.rar



4.20  
8660.zip



4.21  
THE\_WINDERMER\_CHER STERFIELD\_SOFA.rar

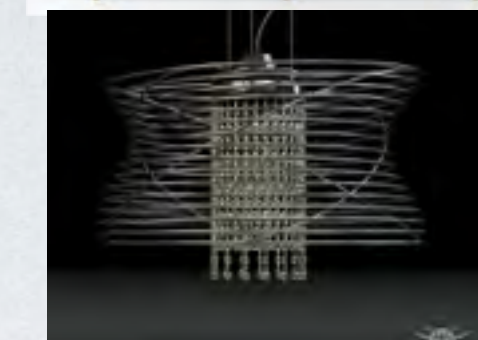

4.22  
WIRE\_LAMP\_STYLE\_D\_3DS.zip



4.23  
HOLLY HUNT LIGHTING BELL JAR.rar

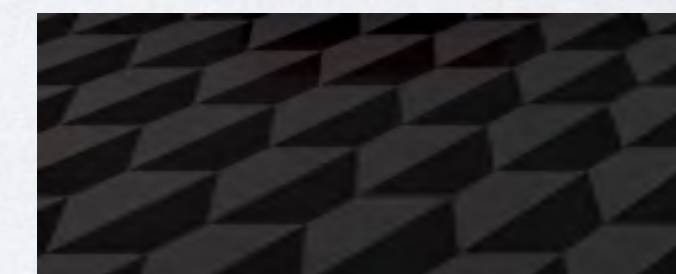

4.24  
PIASTRELLE.c4d.zip



4.25  
SIDETABLE\_I\_3ds.rar



4.26  
3ds.rar



## SPECIALTY LIGHTING : PERIMETER SEATING

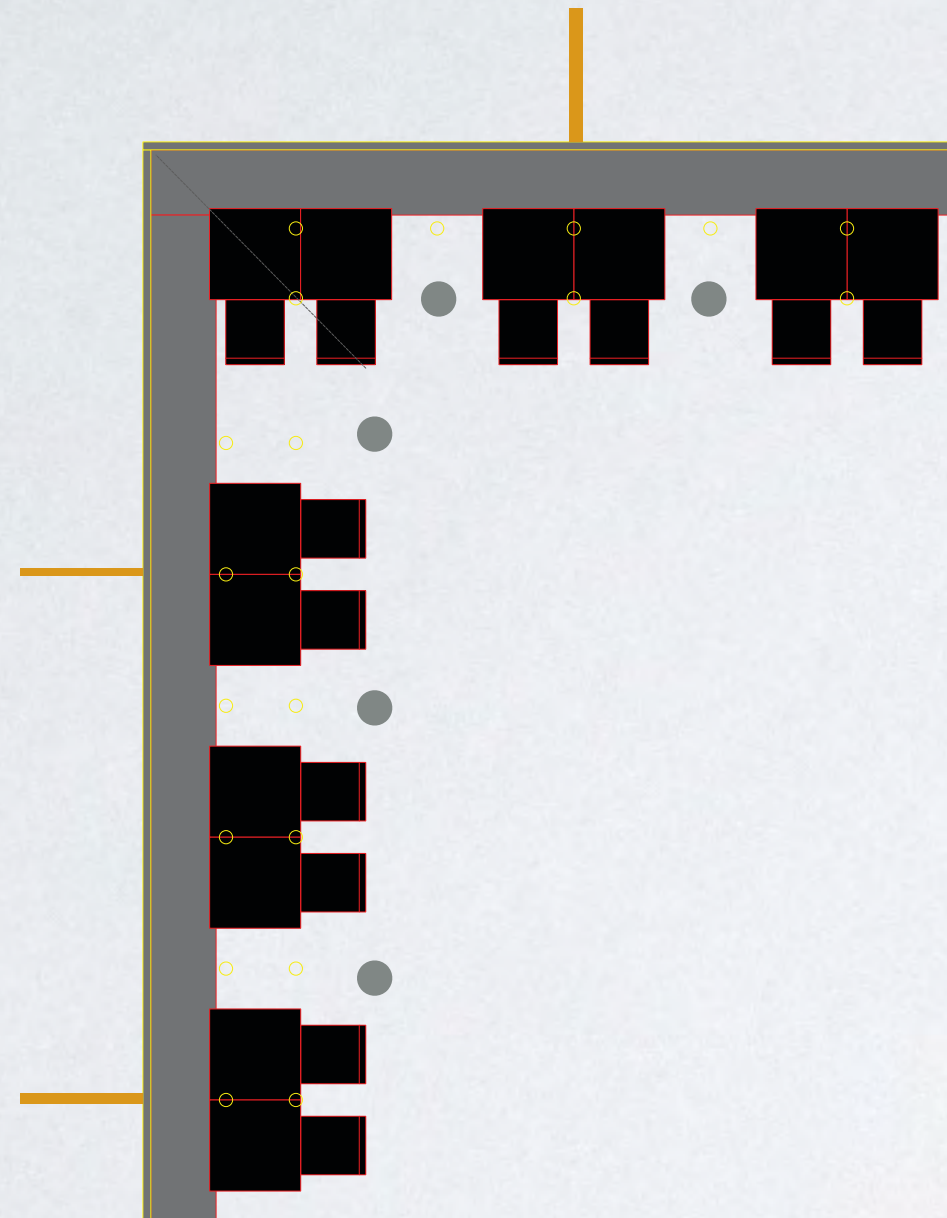

INSET LIGHTING TO CREATE EXTRA DRAMA



POTENTIAL HANGING PENDANT OVER SEATING IF ADDITIONAL LIGHT NEEDED.



DETAILS  
-INTERIOR-